



**SCOUTS®**  
Construir un Mundo Mejor

**ASDE**  
Scouts de Aragón

**Griébal**  
SCOUT CENTRE



# BOOKING

We wait for you  
SCOUT CENTRE



**SCOUTS**  
Construir un Mundo Mejor

**ASDE**  
Scouts de Aragón

**Griébal**  
SCOUT CENTRE







Griébal Scout Centre is an old abandoned town of the Aragonese Pyrenees. In 1990, the Hydrographic Confederation of the Ebro yielded to the Association Scouts of Aragon the use of the urban nucleus of Griébal, in the province of Huesca, as well as its surroundings (700 hectares)

## 1. BRIEF HISTORY OF THE SCOUT CENTER



# GRIEBAL COMARCA SOBRARBE



Griebal is the place where service, volunteering, the environment and scouting are the pillars of coexistence and mutual effort in the achievement of a dream, a challenge that began almost thirty years ago.



**SCOUTS**  
Construir un Mundo Mejor

**ASDE**  
Scouts de Aragón

**Griebal**  
SCOUT CENTRE



## SITUATION



**SCOUTS**  
Construir un Mundo Mejor

**ASDE**  
Scouts de Aragón

**Gribal**  
SCOUT CENTRE





## 2. HOW TO ARRIVE?

Griebal Scout Centre  
Road Aínsa-Campo, Km 429, N260  
L'Ainsa-Sobrarbe 22300 Huesca  
Datum: ETRS89  
Longitud: 0° 12' 3.90"  
Huso UTM: 31  
Coord X: 269.594,61  
Coord Y: 4.696.328,91  
Level: 18

# TRANSPORT

Transport to the Griébal Scout Center:

1) ZARAGOZA-HUESCA-BARBASTRO

La Oscense Buses: 974 21 07 00

BARBASTRO- AINSA

Courteous coaches 976 15 02 83

2) ZARAGOZA-SABIÑANIGO

La Oscense Buses: 974 21 07 00

SABIÑANIGO-AINSA

Coaches Hubedus 974 21 32 77

To travel from Ainsa to the Scout Center there is the possibility of hiring taxis.

TAXI TRAVEL OF 8 PLACES- € 25

## TRANSPORTATION WEBS

GRIEBAL SCOUT CENTRE [www.griebal.org](http://www.griebal.org)  
ZARAGOZA BUS STATION [www.estacion-zaragoza.es](http://www.estacion-zaragoza.es)  
ZARAGOZA URBAN BUS [www.tuzsa.es](http://www.tuzsa.es)  
ZARAGOZA AIRPORT [www.aena.es](http://www.aena.es)  
ZARAGOZA TRAIN STATION [www.adif.es/es\\_ES/infraestructuras/estaciones/4040/informacion\\_000020.shtml](http://www.adif.es/es_ES/infraestructuras/estaciones/4040/informacion_000020.shtml)  
HUESCA AND BARBASTRO BUSES  
[www.alosa.avanzabus.com/index.jsp](http://www.alosa.avanzabus.com/index.jsp)  
AINSA [www.villadeainsa.com/](http://www.villadeainsa.com/)  
PYRENEES INFORMATION  
[www.lospirineos.info/pineta/vallepineta.htm](http://www.lospirineos.info/pineta/vallepineta.htm)



MEALS SCHEDULE	
BREAKFAST	09:00
LUNCH	14:00
SNACK	18:00
DINNER	20:30

\* It is important that the groups that hire full board are very punctual at meal times so as not to imply a disturbance in the center's schedule



### 3. SCHEDULES



\*During this time our Staff / Coordinator will assist you in everything you need any of the groups camped in the center, once that time, although the Staff / coordinator will continue through the center, will not be available to attend you officially, except for the days there are activities outside of that schedule, and / or some urgency arises.

	MORNING	AFTERNOON	EVENING
RECEPTION	De 10:00 a 13:00	De 16:00 a 19:00	
SCOUT STORE	De 10:00 a 13:00	De 16:00 a 19:00	
BAR	De 13:00 a 14:00	De 15:00 a 16:00 De 19:00 a 20:00	De 22:00 a 23:30
STAFF / COORDINATOR	De 8:30 a 14:00*	De 16:00 a 19:30*	



**SCOUTS**  
Construir un Mundo Mejor

**ASDE**  
Scouts de Aragón



## 4. GRIEBAL MAP

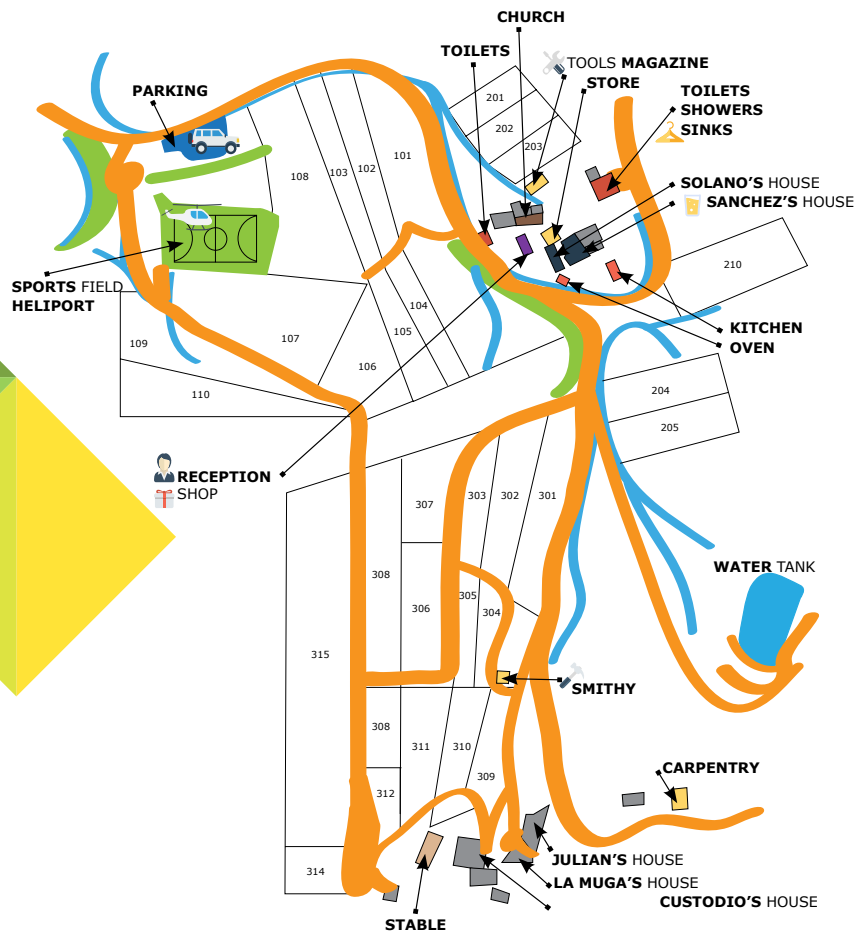

These activities are held one day a week, at a fixed time, for all ages, and are free. They reserve by filling in the activity file and sending it well in advance, since places are limited.

	MONDAY	TUESDAY	WEDNESDAY	JUEVES	FRIDAY
17:00	Searching the chalice		Sport games	Griebal in motion	
21:45		Scout dances			Verbena Scout



## 5. WEEKLY ACTIVITIES



### SEARCHING THE CHALICE

By teams mixed among all the groups, they will have a map where different points of the town will be marked. They will have to go through all the points and overcome the challenges put to them by the staffs who are in each point, who will also tell them the story of Griebal so that they will get to know the whole town.

PLACE: Soccer field.

Monday

TIME: at 5:00 p.m.

Duration: Approx. 2 hours.





## GAMES SPORT

For mixed teams, a football competition and a different sport will be held.

PLACE: Soccer field.

Wednesday

TIME: at 5:00 p.m.

Duration: Approx. 2 hours.



## WEEKLY ACTIVITIES



## SCOUT DANCE

Each group carries a song, game, action prepared to teach the rest of the groups. Between each performance the Staff will perform mini-performances, games, etc ...

PLACE: Labordeta Square.

Tuesday

TIME: at 9.45

Duration: Until 23.45h.





## WEEKLY ACTIVITIES



### **GRIEBAL IN MOTION**

By teams they will compete in different relays.

PLACE: Soccer field.

Thursday

TIME: at 5:00 p.m.

Duration: Approx. 2 hours.

### **VERBENA**

PLACE: Labordeta Square or Bar Terrace

Saturday

TIME: at 9.45

Duration: Until 23.45h.





## 6. GUIDED ACTIVITIES

Choose day of realization, the schedule can be of mornings or afternoons, as long as there is no activity. They are reserved by filling in the activity reservation form.

**PLANTATION WORKSHOP:** Divided with activities for children or adults, finally the planting or care of aromatic herbs is carried out.

**ECOLOGICAL SOAP WORKSHOP:** Differentiated for small or old, soap will be made with used oil and ecological soap with glycerin, which can be used to have in the sinks.





## 7. GUIDED ACTIVITIES

Choose day of realization, the schedule can be of mornings or afternoons, as long as there is no activity. They are reserved by filling in the activity reservation form.

### **RAFTING ESERA RIVER**

Very fun and exciting tour in boats of 8 crew members for a guide. All material is provided, although it is recommended to bring a swimsuit and towel.

DURATION: Approx 3 hours

PRICE: € 31 / person (8km section) € 44 / person (16 km)



**SCOUTS**  
Construir un Mundo Mejor

**ASDE**  
Scouts de Aragón





### **PADDLE SURF**

Walk through the Mediano reservoir, paddling standing on a large surfboard with the help of a paddle. It is easy to learn and accessible for all types of people.

DURATION: Approx 2 hours

PRICE: € 33 / person

### **CANOEING**

Brief explanation of the basic notions about the handling of the boat and then take a walk around the Mediano reservoir.

DURATION: Approx 2-3 hours



## ADVENTURE ACTIVITIES

### **RAVINES**

We will visit the deep gorges carved by the water over the centuries, using rappel and / or jumping techniques to overcome the differences created by the waterfalls.

**DURATION:** Full day

**PRICE:** € 45 /person (water ravine) and €39 /person (dry ravine)

### **VIA FERRATA**

We will walk through a sports itinerary located on a rocky wall, equipped with specific elements: cables, stairs, pegs, steps, Tibetan bridges, etc. To facilitate the progression and optimize the safety of the people who use it. Once up, the descent is made by a normal trail or path of an excursion.

**DURATION:** Approx 2-3 hours

**PRICE:** € 43 /person





## ADVENTURE ACTIVITIES



**SCOUTS**  
Construir un Mundo Mejor

**ASDE**  
Scouts de Aragón

### **ORIENTATION CAREER**

It is an activity to do in the vicinity of the town of Griébal, ideal for working as a team and encourage group work.

Price € 21 / person

### **ARCHERY**

It is an activity to do in the vicinity of the town of Griébal, ideal for working as a team and encouraging group work.

Price: € 19 / person

### **OTHER ACTIVITIES**

Hidrospeed

Bicycle rental ...

If you are interested in doing any of these activities, you can check the reception, the price and the duration of it.

**Griébal**  
SCOUT CENTRE





## 8. SERVICE OF REHABILITATION AND MAINTENANCE OF THE CENTER

The Griébal Scout Center needs the voluntary work of the participants for its reconstruction and maintenance, that is why we offer the service activity so that all those participants who want to collaborate with the reconstruction of the town and its surroundings can participate in this wonderful project.

### **SERVICE FEATURES**

- It adapts to the age of the participants.
- Teams of 10 participants are made.

### **SERVICE RULES**

- Participants must always be accompanied, at least, by a scouter responsible for the group.
- Participants must be equipped with work clothes and hiking boots.
- The indications and orders of the Staff that directs each service must be followed.

The services are adapted to the age of the participants. And to make it more comfortable, they are held in teams of approximately 10 people. Always accompanied by 1 adult responsible for the group, at least. In addition, each team will be accompanied by a staff from the centre.





## SERVICE OF REHABILITATION AND MAINTENANCE OF THE CENTER

### FORESTRY WORK

- Forestry work:
  - o Cutting of trees and treatment.
  - o Pruning of shrubs and trees
  - o Removal of stumps
  - o Weed cleaning
  - o Rehabilitation works.
- Rehabilitation of houses typical of the Aragonese Pyrenees.
  - o Wall arrangements.
  - o Tiled squares and streets.
  - o Wall arrangements.
- Maintenance works
  - o Cleaning of areas and common spaces of the scout centre.
  - o Arrangement of access roads
  - o Cleaning of roads and tracks gutters.
  - o Cleaning of camping area for groups.
  - o Review and maintenance of Scout centre material.





## SERVICE OF REHABILITATION AND MAINTENANCE OF THE CENTER

### REGISTRATION IN SERVICE ACTIVITY

- Fechas: de Lunes a Viernes
- Horario: de 10:00 h a 14:00 h.
- Máximo participantes por día: 30 participantes

### REGISTRATION PROCESS

- 1) Choose the day in which we want to participate.
- 2) Fill out the activity reservation form
- 3) The scout center will confirm your registration in the service activity of the chosen day.

In order to book these services, it is necessary to fill out the booking form for activities, as far in advance as possible, since seats per day are limited.



## 9. EXCURSION TO THE PINETA VALLEY

No. OF PEOPLE	PRICE PER PERSON
From 15 to 21 people	24 €
From 22 to 35 people	18 €
From 36 to 55 people	12 €
8 person taxi	price at reception

**JULIO** los jueves 5, 12, 19 y 26  
**AGOSTO** los jueves 2, 9 y 16

Mínimo de 20 personas (ya sea de un solo grupo o de varios).  
 Jornada completa, excursión a los Llanos de la Larri y Bielsa  
 Salida 10 h

Distancia de Griébal: 55 km.

Precio: los precios varían según el número de personas:

De 15 a 21 personas - 24 €/persona

De 22 a 35 personas - 18 €/persona

De 36 a 55 personas - 12 €/persona

Existe la opción de coger un taxi de 8 personas para realizar esta excursión, consultar el precio en recepción.

[www.scoutsdearagon.org](http://www.scoutsdearagon.org)



# EXCURSIÓN VALLE DE PINETA

Day: every summer Thursday, as long as you sign up for at least 15 people (either from a single group or from several)

Hours: Departure about 10 in the morning. Trip to the Pineta Valley, stopping 30 minutes in Bielsa.

Distance from Griébal: 55km

Duration: Full day.





## CAMPING

Up to 50 people - € 4 / person / night

From 50 to 100 people - 3.75 €/ person / night

More than 100 people - 3.25 € / person / night

## FOOD SERVICE

FULL BOARD €15 person / day

Breakfast € 4 person

Lunch or dinner € 7 person

Pic-nic excursion € 5 person

## KITCHEN RENTAL (for groups of more than 20 people)

It consists of a campaign pavilion or a fixed installation that includes kitchenware, refrigerator, kitchen and the first butane bottle. The replacement of the butane cylinder has a cost according to the market.

Sanchez and Custodio kitchen € 60 / day (50 to 100/120 people)

Marboré cuisine € 60 / day (from 20 to 50/60 people)

## 10. RATES 2018





## RATES 2018

### FRIDGE

We offer the following options:

€15 / day for own refrigerator rental (Up to 10 people)

Use of common fridge:

€ 8 / day for groups of less than 10 people.

€ 14 / day for groups of between 10 and 25 people.

€ 21 / day for groups of between 25 and 50 people

€ 26 / day for groups of between 50 and 100 people.

€ 32 / day for groups of more than 100 people.

### MATERIAL

We offer the following options:

Rental of kitchen stove-camping: € 6 / day

Butane cylinder: (the price will depend on the cost of the market)

Kitchen message kit for 6 people: € 3 / day

Kit of kitchenware for 10 people € 5 / day

Tent 10€ / day

# 11.

## RESERVATION PROCESS

### **1. REGISTRATION PROCESS**

The person who performs the registration process must be the same person who acts as responsible during the visit to Griébal.

The name of the group you register with will be the same as the one you will be recognized during your stay.

### **2. BANK TRANSFERS**

In all bank transfers you make you must indicate the name of the group you belong to, it is very important that it be the same name as the one you use during the registration process.

### **3. CONTACT WITH THE CENTRE'S RESPONSIBLE.**

It is important that the person in charge of the group is in permanent contact with the coordinator of the Centre to coordinate the services and the incidents that may arise during your stay. It is advisable that most of the queries that are made are by this responsible.

e-mail: [Griebal@griebal.org](mailto:Griebal@griebal.org)

mobile: 663 36 75 51

### **4. ARRIVAL AT CENTER**

The first day in the Scout Centre is often complicated. It is very important that you look for the coordinator of the centre or your right to a member of the Staff who will be happy to start the reception process at the entrance of the Scout Centre.

During the reception you will be informed of the regulations of the centre and of all the services and activities that you can do during your stay in Griébal. You will also be asked for a deposit, which will be returned at the end of the stay in Griébal. It is essential to notify the coordinator of the approximate arrival and departure times of the centre, trying to respect the reception schedules.

## BAIL

All groups must leave a deposit for the stay at the centre. The deposit is payable upon arrival at the centre and depends on the number of people:

Up to 20 people: € 50 bail

More than 20 people: € 100 bail

More than 75 people: € 200 deposit.

The deposit will be returned at the end of the camp after a report from the staff of the Griébal Scout Centre, provided that the camping area has been left in good condition and that the school rules have been complied with.

## CANCELLATIONS

The Griébal Scout Centre receives many requests and reservations throughout the year. Places are limited and cancellations are a cause of disruption to the organization of the centre and other groups of scouts.

Cancellation with more than 4 months in advance: full refund of the reservation.

Cancellation more than 2 months in advance: Return of 50% of the reservation.

Cancellation with less than 2 months in advance: Return of 10% of the reservation

## RESERVATION PROCESS



**SCOUTS**  
Construir un Mundo Mejor

**ASDE**  
Scouts de Aragón





The store is located in the same reception, and will be open from Monday to Sunday from 10 am to 1 pm and from 4 pm to 7 pm.

## 12. SCOUT SHOP

In it you can find the following products:

T-shirt € 10

Scarf € 10

Badge € 5

Pin € 1.5

Wood woggle € 4

Steel Mug € 6

Water bottle € 6

Keyring € 4

Tote Bag € 5

Wristbands € 1.5

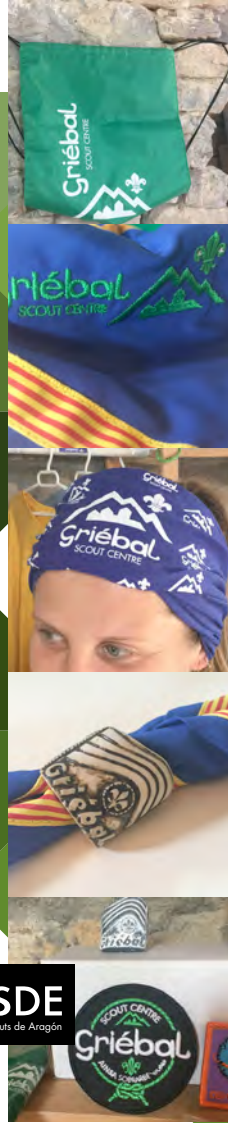

# SCOUT SHOP

**BREAD:** In addition to the products that you can buy in our store, in the centre we have our own bread oven, so you can entrust it to us directly. Each day you will have to order the bars the next day and at reception time. The price is € 1 for each bar.

**FOOD:** We can also manage the food purchases you want to make in Ainsa. To be able to make purchases properly, you will have to always communicate with us the day before and at reception time.

## 15. RULES

### RECEPTION

The first thing you have to do when you arrive is to go through the reception so that they note your arrival and that a Staff will accompany you to your camping area. Confirm, when you finish installing, the exact number and expected visitors during your stay. We have been forced to establish a bond for cleaning the used area and that will be returned to you at the end of the camp once it is verified that everything is in conditions (camps, latrines, used areas, facilities ...)

Before leaving, you regularize your debts (payment of stays, use of kitchen, purchases made, etc.)

The reception will be open during the following hours from 10 am to 1 pm and from 4 pm to 7 pm.

### STAFF / SCOUT CENTRE COORDINATOR

The Griébal Scout Centre has a Volunteer Team that will assist you and help you solve your doubts and incidents.

A weekly meeting is usually held and will be communicated to the coordinators of the activity.

The Griébal Scout Centre has a coordinator, Laura Andreu, the head of the centre.

The staff of the centre will only be available during the following hours: from 8:30 a.m. to 2:00 p.m. and from 4:00 p.m. to 7:30 p.m. Except for emergencies or activities of the centre carried out outside these hours.

### COLLABORATION IN GRIEBAL MAINTENANCE

We offer each group the possibility of working days for maintenance and rehabilitation of Griébal.

We put at your disposal a Person of Staff who together with the group will perform the services with the help of various materials and tools that at the end of the day you will have to return in perfect conditions.

### USE OF FACILITIES.

For those groups that use kitchen and groupware; a list of items that are provided will be delivered. The Group is responsible for returning them in "better" conditions. The use of the kitchen means to leave it clean and tidy after each use.

Water: we are in a region where water is a scarce and precious commodity. Do not waste it. If you see a tap or a hose open, close it. In case you detect a leak, communicate it immediately to the Staff.



**SCOUTS**  
Construir un Mundo Mejor

**ASDE**  
Scouts de Aragón



**Griébal**  
SCOUT CENTRE



# NORMAS DEL CENTRO

## NOISE AND SCHEDULES

Before 8:00 am and after 00:00 the center should be calm due to respect for the other campers.

Respect the common schedules of activities, in case you participate in any of them.

Respect the schedules of the service days in the maintenance and rehabilitation of Griébal.

REMEMBER IT IS IMPORTANT TO RESPECT THE SCHEDULES ALREADY QYUE IF WE DO NOT DO IT ALSO WE CAN HARM THE REST OF THE GROUPS.

## CAMPING ZONES

Each group has its own camping area assigned. There are also areas in the Scout Center that are common. Respect them

Each group is responsible for their camping area, usually and at the end of the camp, they are clean. Next to each camping area there are bathrooms, showers, toilets and sinks. They should always be clean, cleaning as many times as necessary. A cleaning shift will be established for the groups.

No fire can be lit.

If in the course of the camp there is any breakage or breakage communicate with the head of the scout center as soon as possible.

Be respectful with nature.

Keep in mind that our climate goes from a strong heat to the possibility of strong summer storms with abundant rain.

## INSTALLATIONS OF THE SCOUT CENTER

The Griébal Scout Center has several facilities:

First aid kit. Reception / Scout Store. Mail service. Bar. Soccer field. Parking.

Some areas of the Scout Center have prohibited access (areas in ruins, rehabilitation areas, etc.)

Respect the signs. The Camp Directors will notify that circumstance to their campers and will prevent any of their members from accessing them. To load and unload you can take the car to the camping areas, the rest of the time must be in the Parking.

## OUT OF THE SCOUT CENTER

The Griébal Scout Center is a meeting place for many scouts, for the image of the group and the center, if you visit Ainsa or the surrounding villages to be educators and responsible.

## IMPORTANT

Alcohol is banned throughout the Scout Center by the Youth Activities Act of the Government of Aragón. Any breach will result in immediate expulsion from the group. Smoking is only allowed on the terrace of the bar.

**The presence of pets is prohibited throughout the Center.**

**The Directors of the Camps are directly responsible for the actions of their members.**



**SCOUTS**  
Construir un Mundo Mejor

**ASDE**  
Scouts de Aragón

